

**GUYURA RCPC AREA**  
CONCEPT DESIGN  
SEPTEMBER 2021





**Legend**

- Native Grass
  - Revegetation
  - Walk-in Campsite
  - Proposed path
  - Proposed family space
  - Proposed furniture
  - Road/Car Park
  - Raingarden
  - Proposed interpretation
  - Proposed amenities
  - Granite outcrops
  - Trailhead
- 
- 01 New toilet block
  - 02 Welcome area & orientation signage
  - 03 Yarning circle shelter
  - 04 Existing stone shelter
  - 05 Exploration space
  - 06 Bus bay, pick-up & drop off
  - 07 DDA car space & accessible path
  - 08 Path connection to lookout trail
  - 09 Dry creek bed & seasonal ponds
  - 10 Accessible path to shelter
  - 11 Cultural area
  - 12 Path connection to southern trails
  - 13 Walk-in campsites
  - 14 Maintenance vehicle access gate
  - 15 Day visitor facilities & shelter
  - 16 Pedestrian crossing
  - 17 Dry creek bed interpretation
  - 18 Creek line under car park

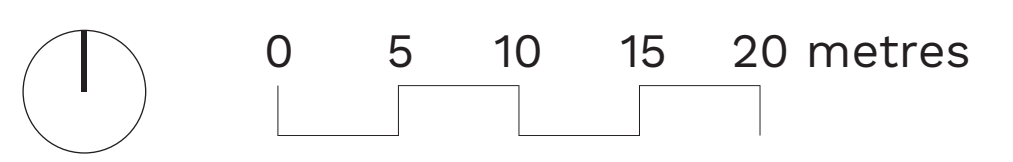

**PICNIC AREA** *a place to meet, gather, tell stories and experience the landscape*

# GUYURA RCPC AREA CONCEPT DESIGN







PICNIC AREA - A place to tell stories and experience the landscape (Artist Impression)



Sand play



Dry creek bed



Balance logs



Shelter hoops



Djaara language activities



Maze poles

PICNIC AREA *a place to meet, gather, tell stories and experience the landscape*

# GUYURA RCPC AREA CONCEPT DESIGN



**3 Acres**  
Landscape Architecture

Issue: V3 2021\_10\_12





## CAMPING AREA

# GUYURA RCPC AREA CONCEPT DESIGN



**3 Acres**  
Landscape Architecture

Issue: V3 2021\_10\_12



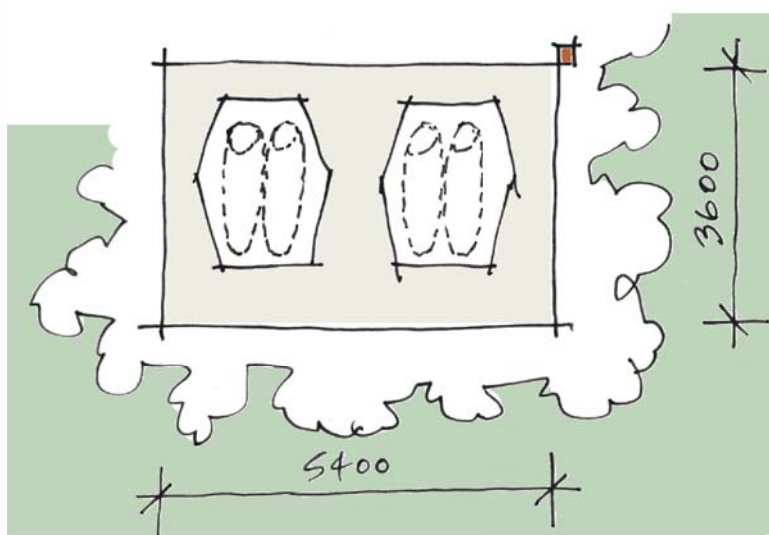
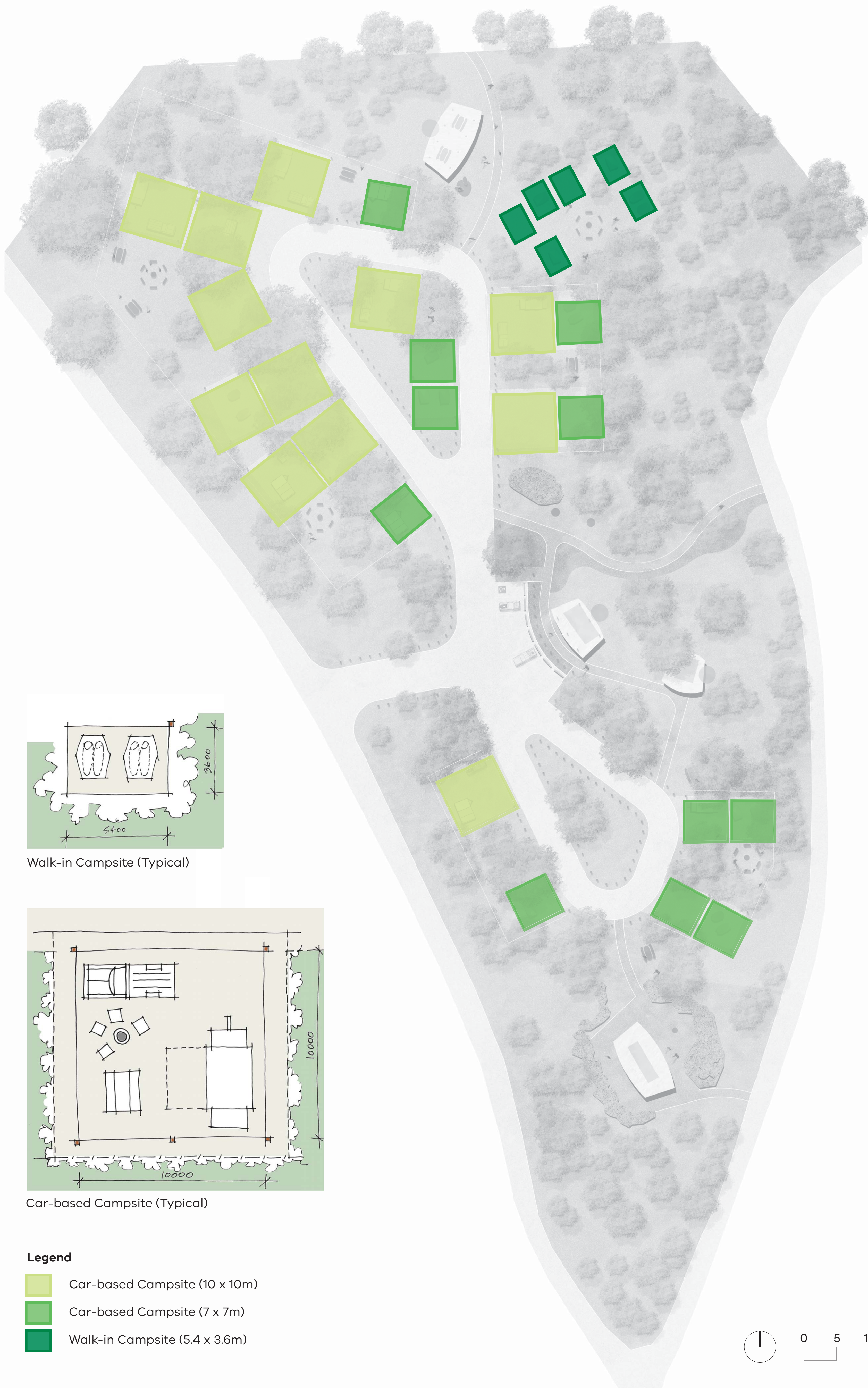

Walk-in Campsite (Typical)

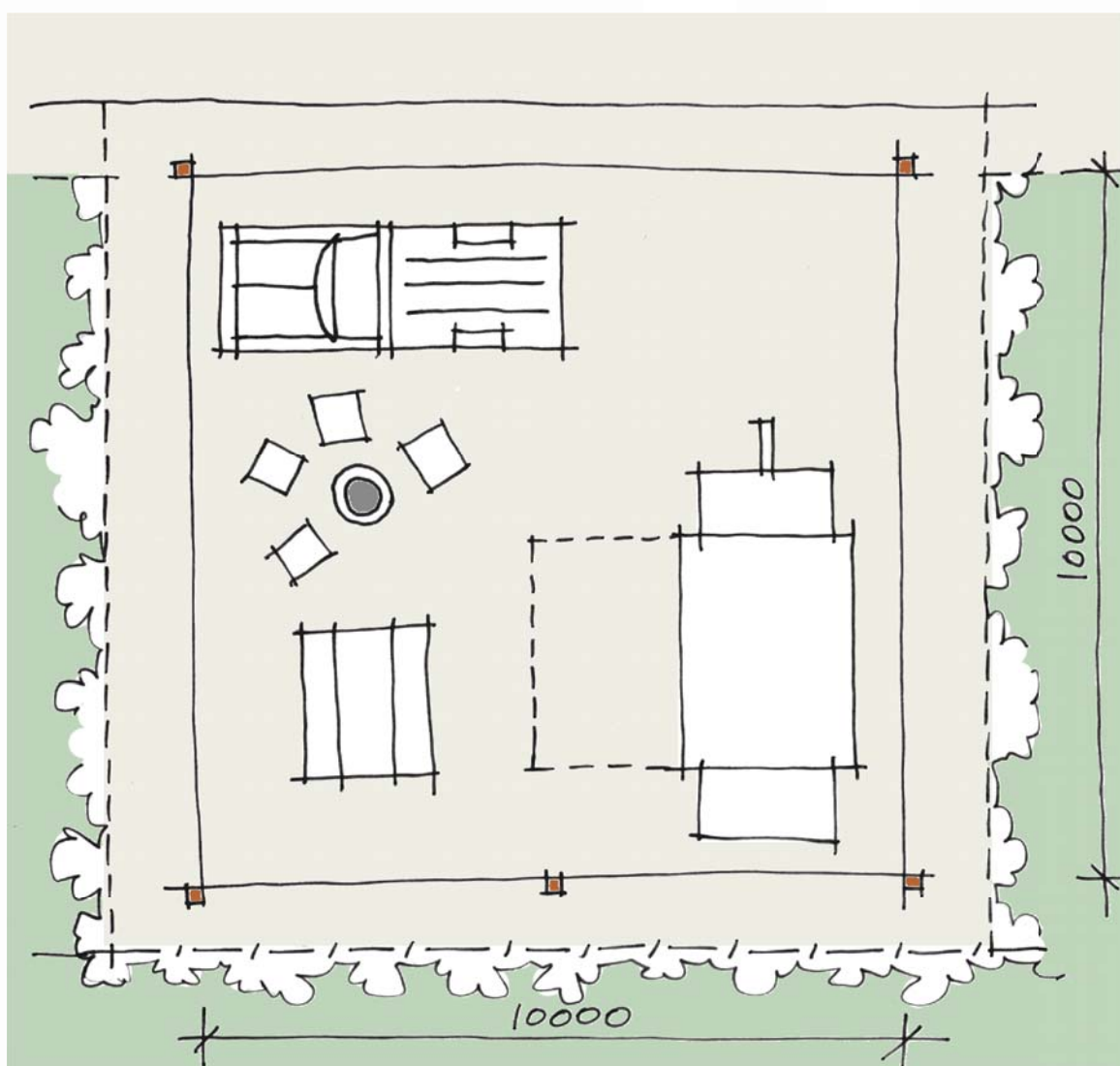

Car-based Campsite (Typical)

#### Legend

- Car-based Campsite (10 x 10m)
- Car-based Campsite (7 x 7m)
- Walk-in Campsite (5.4 x 3.6m)

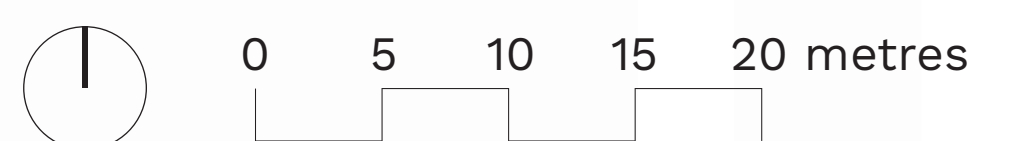

## CAMPING AREA

# GUYURA RCPC AREA CONCEPT DESIGN



**3 Acres**  
Landscape Architecture

Issue: V3 2021\_10\_12





#### Legend

- Native Grass
- Revegetation
- Walk-in Campsite
- Proposed path
- Proposed family space
- Proposed furniture
- Road/Car Park
- Proposed interpretation
- Proposed amenities
- Granite outcrops
- Trailhead

#### Key

- 01 New interpretation and picnic shelter
- 02 Welcome area & orientation signage
- 03 Interpretation signage
- 04 Proposed new trail to lookouts,
- 05 Accessible path to shelter
- 06 Steps to shelter
- 07 Revegetation
- 08 Accessible path to shelter
- 09 Existing trees
- 10 Proposed new return path from lookouts
- 11 Path connection to camping area
- 12 Path connection to southern trails
- 13 Existing entrance road
- 14 Island planting
- 15 Bus bay, pick-up & drop-off
- 16 DDA car space & accessible path
- 17 Possible future picnic shelter
- 18 Possible future public toilets

#### Notes

There will be further engagement and investigation as part of the detailed design of the three hubs.

This additional work includes:

- Cultural heritage assessments.
- Traffic engineering assessments, to review and confirm road and carpark requirements.
- Tree and vegetation assessments, to guide the final location and layout of new design features.
- Access and inclusion assessments.
- Identification of Djaara artist opportunities, including commissioned artworks, signage and interpretive elements.
- Planting design, using indigenous species and plants of significance to Dja Dja Wur-rung.
- Detailed design of furniture and park infrastructure.

## LOOKOUT CARPARK

# GUYURA RCPC AREA CONCEPT DESIGN



**3 Acres**  
Landscape Architecture

Issue: V3 2021\_10\_12